

Visual Identification

(b) GM SP0 Group Numbers (cont'd)

Steering Column - Disassembled View

Tilt Steering Column

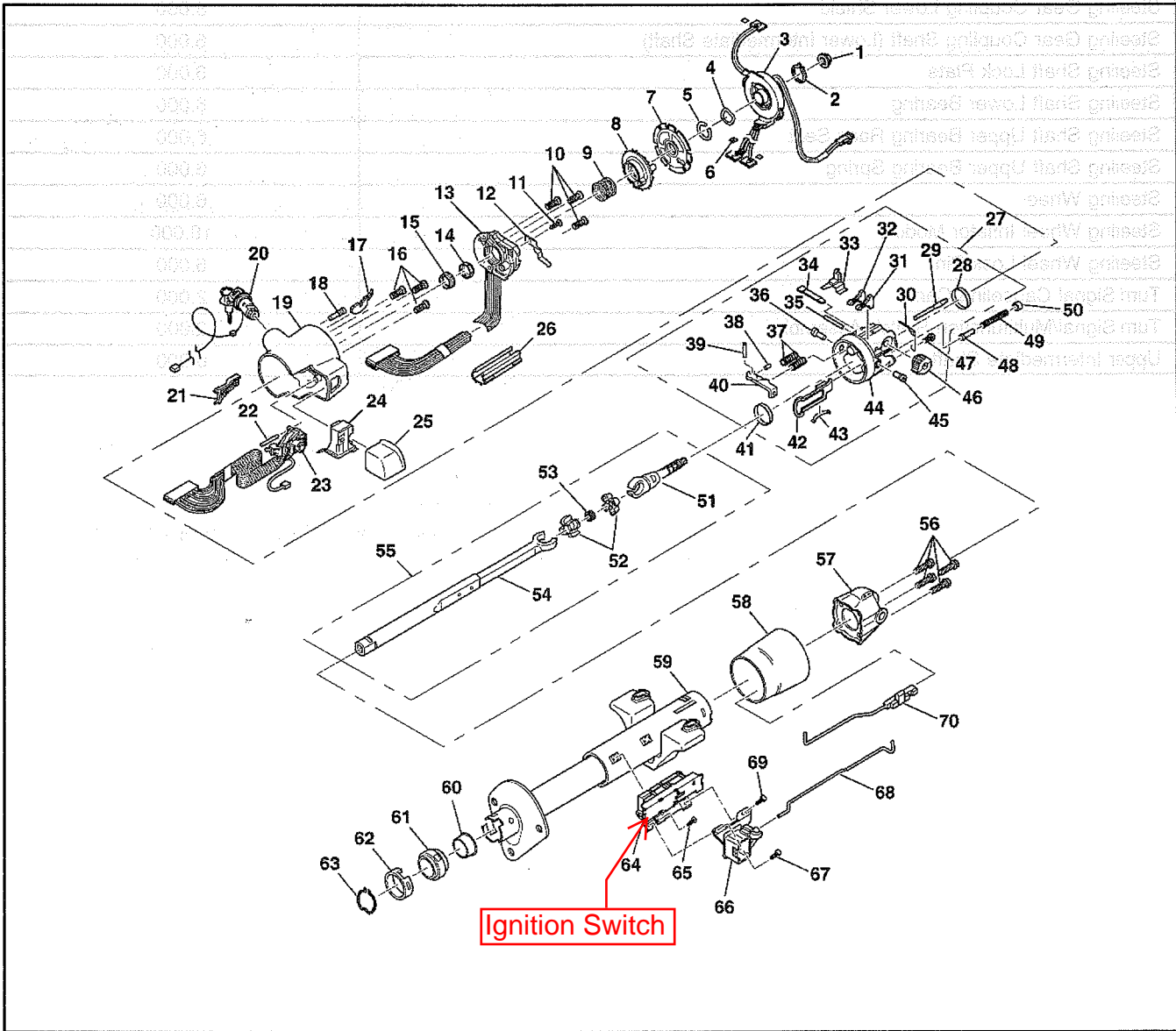

393980

Legend

- |                                     |   |
|-------------------------------------|---|
| (1) Flanged Prevailing Torque Nut   | (13) Turn Signal Switch Assembly            |
| (2) Retaining Ring                  | (14) Upper Bearing Inner Race Seat          |
| (3) SIR Coil Assembly               | (15) Inner Race                             |
| (4) Wave Washer                     | (16) Pan Head 6-Lobed Socket Screw          |
| (5) Bearing Retainer                | (17) Buzzer Switch Assembly                 |
| (6) Connector Shroud                | (18) Lock Retaining Screw                   |
| (7) Shaft Lock Shield Assembly      | (19) Lock Housing Cover and Sleeve Assembly |
| (8) Turn Signal Cancel Cam Assembly | (20) Steering Column Lock Cylinder Set      |
| (9) Upper Bearing Spring            | (21) Dimmer Switch Rod Actuator             |
| (10) Pan Head 6-Lobed Socket Screw  | (22) Switch Actuator Pivot Pin              |
| (11) Round Washer Head Screw        | (23) Pivot and Pulse Switch Assembly        |
| (12) Signal Switch Arm Assembly     | (24) Column Housing Cover End Base Plate    |

(25) Column Housing Cover End Cap	(48) Spring Guide
(26) Wiring Protector	(49) Wheel Tilt Spring
(27) Steering Column Housing Assembly	(50) Spring Retainer
(28) Bearing Assembly	(51) Race and Upper Shaft Assembly
(29) Lock Bolt	(52) Centering Sphere
(30) Lock Bolt Spring	(53) Joint Preload Spring
(31) Steering Wheel Lock Shoe	(54) Lower Steering Shaft Assembly
(32) Steering Wheel Lock Shoe	(55) Steering Shaft Assembly
(33) Wire Protector Shield	(56) Hexagon Washer Head Tapping Screw
(34) Drive Shaft	(57) Steering Column Housing Support Assembly
(35) Dowel Pin	(58) Steering Column Housing Shroud
(36) Pivot Pin	(59) Steering Column Jacket Assembly
(37) Shoe Spring	(60) Lower Bearing Adapter
(38) Release Lever Spring	(61) Bearing Assembly
(39) Release Lever Pin	(62) Bearing Adapter Retainer
(40) Shoe Release Lever	(63) Lower Bearing Adapter Clip
(41) Bearing Assembly	(64) Ignition Switch Assembly
(42) Switch Actuator Rack	(65) Flat Head Screw
(43) Rack Preload Spring	(66) Dimmer Switch Assembly
(44) Steering Column Housing	(67) Hexagon Washer Head Tapping Screw
(45) Pivot Pin	(68) Dimmer Switch Rod
(46) Switch Actuator Sector	(69) Washer Head Screw
(47) Hexagon Washer Head Screw	(70) Ignition Switch Rod Actuator Assembly

\* A stuck ignition switch  
 \* A restricted actuator rod  
 \* An incorrectly installed sector

Key Cannot Be Removed in the Off Lock Position

Action	Problem
Inspect the column for the following conditions: * An incorrectly set ignition * A damaged lock cylinder	The key cannot be removed in the OFF-LOCK position.

Lock Cylinder Can Be Removed Without Depressing Retainer

Action	Problem
Inspect the lock cylinder for a missing lock cylinder retaining screw.	The lock cylinder can be removed without depressing the retainer.

High Lock Effort Between the Off Lock Positions

Action	Problem
Inspect the lock cylinder for a distorted rack.	High effort is required in the lock cylinder between the OFF and OFF-LOCK positions.